

Fuse switch disconnecter 100A

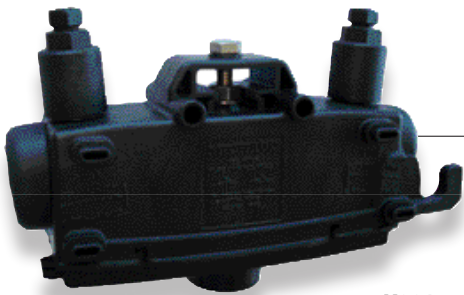

K291

Rating 100A  
Fuse size 22x58  
Conductors section 6-95mm<sup>2</sup>

Application

This Fuse Switch Disconnecter (FSD) is a single phase device. It is installed at the top of pole or on façade. It protects the overhead connection supplying an individual customer and the low voltage network.  
It is designed to receive a neutral tube or a 100A maximum, size 22x58 fuse cartridge (according to the IEC 269-2.1 standard).

Description

- The FSD ratings are:
    - Rated voltage, Ue : 500V
    - Rated frequency : 50 up to 60Hz
    - Rated insulation voltage, Ui : 1 000V
    - Rated current, Ie : 100A
  - The terminals are completely insulated. Connection is established using insulation piercing technology.
  - The insulated conductor section ranges from 6 up to 95mm<sup>2</sup> Al/Cu.
  - The tightening efficiency of the conductors is ensured by two shear head screws on top body.
  - The fuse holder is opened, removed and closed using a pigtail stick.
- Note: the fuse holder can be installed without fuse.
- The polarity test points are accessible on each terminal without removing the fuse holder.
  - The fuse holder can be sealed if necessary. The protection degree is IP33.

This fuse switch disconnecter meets the criteria of the IEC 60 947-3 and IEC 60 269-2 standards.

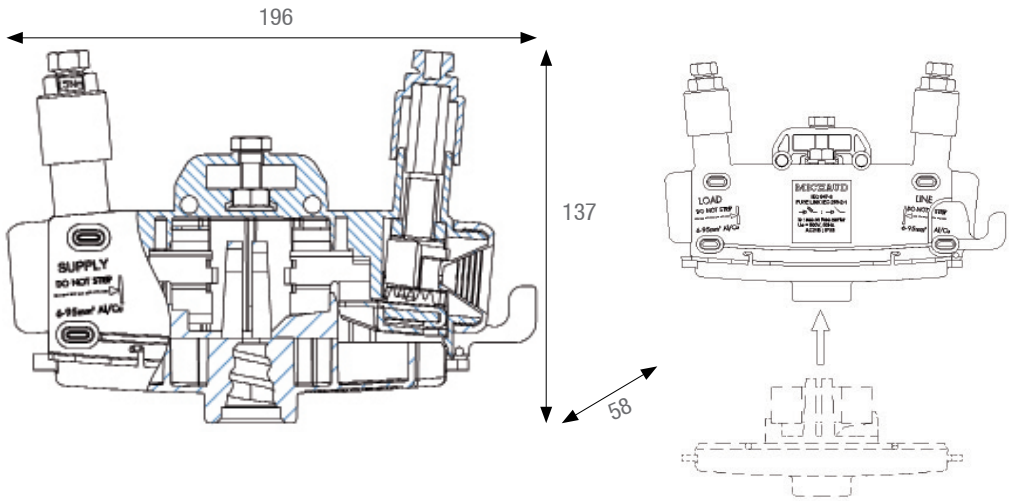

K291

Dimensions in mm

Code	Designation	Weight (kg)	Sales unit
K291	SINGLE PHASE FSD 100A (22x58) PIERCING 6-95	0.510	1

Costumised solution:

- Several options available:
- For the fuse presence indicator, add **P** to the reference.
  - For the blown fuse LED indicator, add **L** to the reference.
  - For the shear head indicator, add **H** to the reference.
  - For the customer identification number, add **N** to the reference.
  - For the colour of the fuse carrier, add **C** to the reference and specify the colour (black is standard colour).

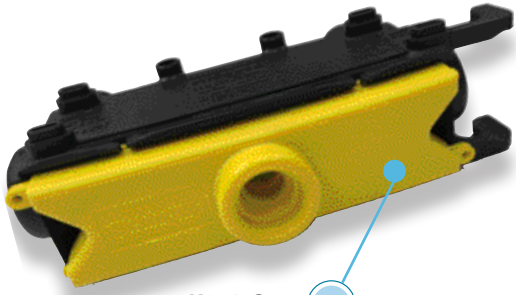

K291-C  
Colour of the fuse carrier



Accessories

The bracket is made of galvanised steel highly resistant to corrosion. Fixing on a pole or façade is achieved by two 10mm diameter galvanised steel screws and two holes on the bracket (top hole having a key shape to make it easier to position the FSD).  
The adaptor made of synthetic materials is designed to fix a fuse switch disconnecter on a "swan neck" type bracket. It can also be fixed using a strap or 2 screws.



K297 K295

Code	Designation	Weight (kg)	Sales unit
K297	METAL BRACKET FOR SINGLE PHASE FSD	0.490	30
K295	PLASTIC ADAPTOR FOR SINGLE PHASE FSD BRACKET	0.070	5

SEE SHEET  
PROTECTION / Operating stick

SEE SHEET  
PROTECTION / Fuses

Installation video available on [www.michaud-export.com](http://www.michaud-export.com)